

Anclajes Químicos

MORTERO POLYESTER



MATERIALES DE USO:



RECOMENDADO PARA:



REF.	MEDIDA	U / E
3000.50.061	300 ML	1 / 12 Uds.
--	--	--

CÁNULA MEZCLADORA

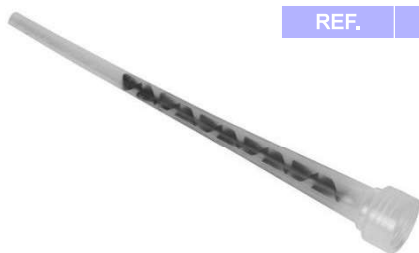

REF. 3000.50.064

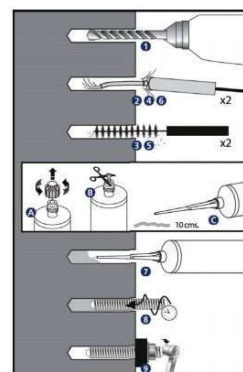

TAMIZ DE PLÁSTICO

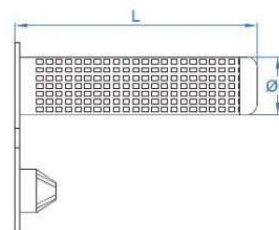

REF.	L	D	U / E
3000.50.062	12	50	12 Uds.
3000.50.063	16	85	12 Uds.